



techsystem

automatyka klimatyzacja wentylacja

▸ zapoznaj się z naszą ofertą

Liquid or Air Pressure Transmitter PT-5217

Introduction

The PT-5217 Pressure Transmitter accurately measures pressure and converts the measurement into a standard proportional 0...10 V signal. The PT-5215 is especially adapted to measure air, water and inert gases pressure.

The PT-5217 can also be used in pneumatic control systems to convert pneumatic into electric standard signals.



PT-5217 Pressure Transmitter

Features and Benefits	
<input type="checkbox"/> Low zero drift/time	
<input type="checkbox"/> Low sensibility to ambient temperature change	
<input type="checkbox"/> Low hysteresis	Can be used in a lot of applications, which require accurate and stable pressure measurement
<input type="checkbox"/> High accuracy	
<input type="checkbox"/> Direct mounting, 1,5 m cable included	Saves installation time
<input type="checkbox"/> Splash proof enclosure	Suitable for indoor/outdoor applications

Operation

The PT-5217 signal, provided by a new ceramic piezo-resistive chip pressure sensing element, will proportionally increase as the pressure of the medium increases.

Ordering data

PT-5217-7 

Operating range

01	0...1 bar
10	0...10 bar

Accessories

EQ-6056-7000	Mounting set, incl. compression nut for 4x6 mm plastic tubing and surface mounting (see also under "Dimensions")
EQ-0100-7001	Accessories for DIN rail mounting

Mounting instructions

The PT-5217 is suitable for direct mounting on a G 1/4" female connection. An EPDM O-Ring is provided for tight connection (air application).

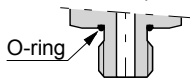

Use accessories EQ-6056-7000 and/or EQ-0100-7001 for surface or DIN rail mounting

Wiring diagram

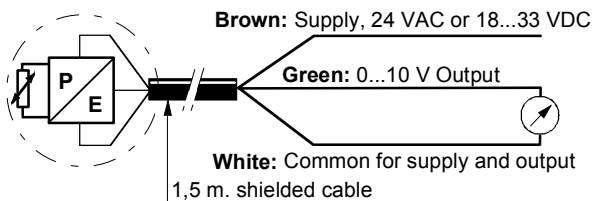

Dimensions (mm)

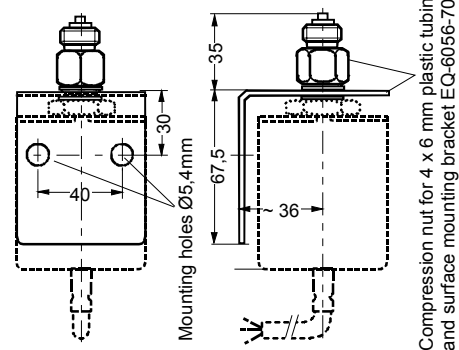
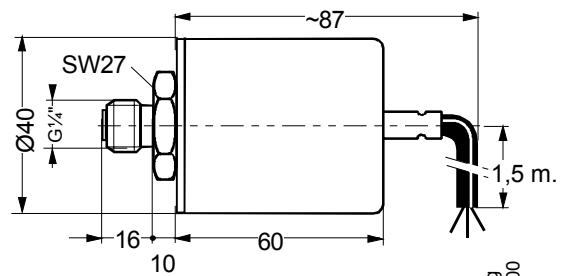

Compression nut for 4 x 6 mm plastic tubing and surface mounting bracket EQ-6056-7000

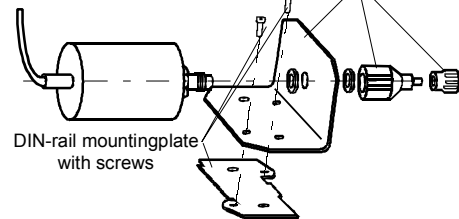

EQ-0100-7001

Specifications

Medium	Air, water and inert gases
Operating ranges	0...1 bar or 0...10 bar, see "Ordering Data"
Supply voltage	24 VAC +15/-10%, 50/60 Hz or 18...33 VDC, max. 5 mA
Output	0...+10 V, max. 1 mA (> 10 kΩ)
Housing	Aluminum
Pressure connection	G 1/4", Stainless steel 1.4305 with EPDM gasket
Cable connection	1,5 m shielded cable, 3 wires
Protection class	IP65, (IEC 144)
Action	Proportional direct acting
Storage conditions	-15 to +80 °C
Ambient Operating conditions	-15 to +80 °C
Max. allowed Pressure	200% of operating range
Measuring time constant	5 ms.
Linearity, Hysteresis and Repeatability	< ± 0,5% of operating range in total
Temperature drift	0,05% per K of operating range typical
Weight	0,2 kg
CE Conformity	EMC (89 / 336 EEC), EN 50081-1, EN 50082-1

The performance specifications are nominal and conform to acceptable industry standards. For application at conditions beyond these specifications, consult the local Johnson Controls office. Johnson Controls, Inc. shall not be liable for damages resulting from misapplication or misuse of its products.

Johnson Controls International, Inc.

Headquarters: Milwaukee, WI, USA

European headquarters: Westendhof 8, 45143 Essen, Germany

European Factories: Lomagna (Italy), Leeuwarden (The Netherlands), Essen (Germany)

Branch Offices: principal European Cities

Printed in Germany