



# techsystem

automatyka klimatyzacja wentylacja

▸ zapoznaj się z naszą ofertą

Valves

VG8300N and H Series Flanged Valves (1/2)



VG8000N and H Series Flanged Valves

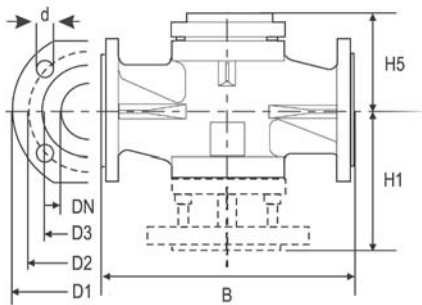

Dimensions in mm

| DN  | B   | D1  | D2  | D3  | d    | H1  | H5  | Bolts    | Holes |
|-----|-----|-----|-----|-----|------|-----|-----|----------|-------|
| 40  | 200 | 150 | 110 | 88  | 17.5 | 140 | 78  | M16 x 55 | 4     |
| 50  | 230 | 165 | 125 | 102 | 17.5 | 145 | 101 | M16 x 60 | 4     |
| 65  | 290 | 185 | 145 | 122 | 17.5 | 156 | 102 | M16 x 60 | 4     |
| 80  | 310 | 200 | 160 | 138 | 17.5 | 180 | 108 | M16 x 65 | 8     |
| 100 | 350 | 220 | 180 | 158 | 17.5 | 225 | 136 | M16 x 70 | 8     |
| 125 | 400 | 250 | 210 | 188 | 17.5 | 255 | 155 | M16 x 75 | 8     |
| 150 | 480 | 285 | 240 | 212 | 22   | 290 | 175 | M20 x 75 | 8     |

Description

The VG8300N PN 16 and VG8300H PN 25 valve series are designed primarily to regulate the flow of water and steam in response to the demand of a controller, in heating, ventilating and air conditioning systems. These 2-way PDTTC (normally open), nodular cast iron valves have a specially designed plug, which through specific balancing of pressures allows higher close-off pressures with standard actuator combinations. The VG8300N and VG8300H valves can be used with a variety of Johnson Controls pneumatic and electric actuators.

Features

- PN16 and PN 25 nodular iron bodies
- DN40...DN150
- Kvs 25...350
- 2-way PDTTC
- Fluid temperature 2...180 °C (PN16 Valves) with Glycerin cup -10...180 °C (PN16 Valves)
- Fluid temperature 2...200 °C (PN25 Valves) with Glycerin cup -20...200 °C (PN25 Valves)
- Pressure balanced valve plug

Valves

VG8300N and H Series Flanged Valves (2/2)

VG8300N Series 2-way Balanced Pressure Valve, PDTC (normally open), PN16, Valves and Actuators - Selection Table

| Valve Size | Kvs | Nominal Stroke (mm) | Close Off Pressure kPa |                  |                        |                        |                 | Ordering Codes * |           |           |
|------------|-----|---------------------|------------------------|------------------|------------------------|------------------------|-----------------|------------------|-----------|-----------|
|            |     |                     | Non Spring Return      |                  |                        |                        | Spring Return   |                  |           |           |
|            |     |                     | VA78xx<br>1000 N       | VA1125<br>2500 N | RA-3100-8126<br>1200 N | RA-3100-8226<br>1700 N | VA1x20<br>2000N |                  |           |           |
| DN40       | 25  | 13                  | 1600                   | 1600             | 1600                   | ---                    | 1600            | VG83E1S1N        |           |           |
| DN50       | 40  | ---                 | 1600                   |                  | ---                    | 1600                   |                 | 1600             | VG83F1S1N |           |
| DN65       | 63  |                     |                        |                  |                        |                        |                 |                  | 25        | VG83G1S1N |
| DN80       | 100 |                     |                        |                  |                        |                        |                 |                  | 42        | VG83H1S1N |
| DN100      | 160 | 42                  | 1500                   | ---              | 1600                   | 1500                   | 1500            | VG83J1S1N        |           |           |
| DN125      | 250 |                     |                        |                  |                        |                        |                 | 1400             | 1400      | VG83K1S1N |
| DN150      | 350 |                     |                        |                  |                        |                        |                 | 1400             | 1000      | VG83L1S1N |

Notes: \*

- For factory mounted valve actuators just add "+M" to the actuator ordering code
- For ordering a valve with Glycerine cup packing, add suffix "20" to the ordering code: i.e. VG8xxxS1N20

Notes: \*\*

- For fluid temperature >140 °C the extension kit VA1000-EP must be mounted.

VG8300H Series 2-way Balanced Pressure Valve, PDTC (normally open), PN25, Valves and Actuators - Selection Table

| Valve Size | Kvs | Nominal Stroke (mm) | Close Off Pressure kPa |                  |                        |                        |                 | Ordering Codes * |           |           |
|------------|-----|---------------------|------------------------|------------------|------------------------|------------------------|-----------------|------------------|-----------|-----------|
|            |     |                     | Non Spring Return      |                  |                        |                        | Spring Return   |                  |           |           |
|            |     |                     | VA78xx<br>1000 N       | VA1125<br>2500 N | RA-3100-8126<br>1200 N | RA-3100-8226<br>1700 N | VA1x20<br>2000N |                  |           |           |
| DN40       | 25  | 13                  | 2500                   | 2500             | 2500                   | ---                    | 2500            | VG83E1S1H        |           |           |
| DN50       | 40  | ---                 | 2500                   |                  | ---                    | 2500                   |                 | 2500             | VG83F1S1H |           |
| DN65       | 63  |                     |                        |                  |                        |                        |                 |                  | 25        | VG83G1S1H |
| DN80       | 100 |                     |                        |                  |                        |                        |                 |                  | 42        | VG83H1S1H |
| DN100      | 160 | 42                  | 1900                   | ---              | 2500                   | 2000                   | 2000            | VG83J1S1H        |           |           |
| DN125      | 250 |                     |                        |                  |                        |                        |                 | 1400             | 1400      | VG83K1S1H |
| DN150      | 350 |                     |                        |                  |                        |                        |                 | 1500             | 1000      | VG83L1S1H |

Notes: \*

- For factory mounted valve actuators just add "+M" to the actuator ordering code
- For ordering a valve with Glycerine cup packing, add suffix "20" to the ordering code: i.e. VG8xxxS1N20

Notes: \*\*

- For fluid temperature >140 °C the extension kit VA1000-EP must be mounted.