



techsystem

automatyka klimatyzacja wentylacja

▸ zapoznaj się z naszą ofertą

Modulating Water Valves

V46SA Pressure Actuated Water Valve, Low Flow



V46SA Low Flow

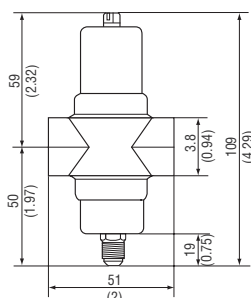

Dimensions in mm (inches)

Description

The V46SA is a direct acting, "all range", pressure actuated modulating valve, used to control the waterflow to a condenser by directly sensing pressure changes in a non-corrosive refrigerant circuit. The V46SA is specially designed for use on equipment requiring a low condenser waterflow such as icemakers, small heatpumps and watercoolers. The springhousing and power element are rolled to the valve body.

Rubber diaphragms seal the water away from the range spring and bellows part so these are not submerged in water where they would be subject to sedimentation and corrosion.

The valve can be ordered style 5 (without capillary), style 13, style 34 and style 50 (incl. 75 cm capillary). The capillary part will be delivered separated from the valve.

Features

- Valve designed for low flow
- "All range" power element and spring housing
- Small dimensions
- Pressure actuated
- Various pressure connection style
- High refrigerant pressure resistant bellows

Selection Table

Range (bar)	Body Style	SizeThread according to ISO 228	Style	Capillary Length	Additional Features It is possible to change Style 13 into Style 45A by ordering KIT031N600	Ordering Codes
5...23	Straight	3/8 "	45A	75	Capillary soldered to power element	V46SA -9101
			50		Capillary separate	V46SA -9110
			5	-		V46SA -9300
			13	75	Capillary separate	V46SA -9600
			34		Capillary soldered to power element	V46SA -9950
					V46SA -9951	

* Quantity orders only